

## Cast iron Gate Valve inside screw brass trim PN16 High Temperature with consol-flange ISO5210

### Main characteristics

- Manufactured in accordance with EN 1171
- Face-to-face length according to EN 558-1, basic series 15
- Flanged according to EN 1092-2 PN16 with raised face undrilled, PN10 or other specifications on request
- Inside screw thread clockwise closing, with 2 O-rings
- Minimal pressure drop
- Hydrostatically tested according to EN 12266-1: Test type P11-P12 Rate A
- Pressure Equipment Directive 2014/68/UE Group 2
- 100% full bore
- Gate valves are bi-directional and can be installed in any position. However, the preferred orientation is with the stem pointing vertically upwards.

### Field of application

- Industrial plants
- Sewage water
- Water treatment
- Air-conditioning systems (HVAC)
- Central heating and cooling circuits
- Non-aggressive fluids
- Tanks
- Irrigation
- Fuel

### Corrosion protection

- Standard version: externally coated with Phenolic-oil resin with zinc-phosphate high corrosion resistance painting Grey Ral 7011
- On request: integrally epoxy coated
- Customized color available



### Ratings

|                            |             |              |
|----------------------------|-------------|--------------|
| Working temperature (°C)   | -10 to +120 | +120 to +150 |
| Max Working pressure (bar) | 16          | 14           |

### Hydrostatically tested according to EN 12266-1 (bar)

|               |                     |                   |
|---------------|---------------------|-------------------|
| P11 Body test | P12 Seat Test water | P12 Seat test air |
| 24            | 18                  | 6                 |

### Material specification

| Nr | Parts                 | Material                     | Specification |
|----|-----------------------|------------------------------|---------------|
| 1  | Consol-flange ISO5210 | Zinc-plated carbon steel     | A105          |
| 2  | O-ring                | DF801 FKM 80SH               | -             |
| 3  | Gasket                | Fasit 205                    | -             |
| 4  | Stem                  | X12Cr13 stainless steel      | AISI 410      |
| 5  | Bonnet                | EN-GJL-250 grey cast iron    | EN 1561       |
| 6  | Gasket                | Fasit 205                    | -             |
| 7  | Motherscrew           | Carbon steel                 | A105          |
| 8  | Wedge DN 40-DN 65     | CB 754-S GM cast brass       | EN 1982       |
| 8  | Wedge DN 80-DN 300    | EN-GJL-250 grey cast iron    | EN 1561       |
| 9  | Seats                 | CB 754-S GM cast brass       | EN 1982       |
| 10 | Body                  | EN-GJL-250 grey cast iron    | EN 1561       |
| 11 | Nut                   | Zinc-plated 8.8 carbon steel | ISO 4032      |
| 12 | Screw                 | Zinc-plated 8.8 carbon steel | EN ISO 4017   |

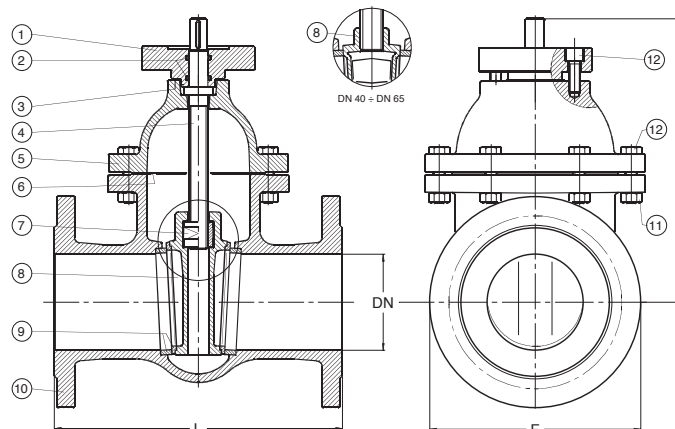

### Technical data

| DN                         | 40  | 50   | 65  | 80  | 100   | 125   | 150   | 200   | 250   | 300   |
|----------------------------|-----|------|-----|-----|-------|-------|-------|-------|-------|-------|
| F mm                       | 150 | 165  | 185 | 200 | 220   | 250   | 285   | 340   | 405   | 460   |
| L mm                       | 240 | 250  | 270 | 280 | 300   | 325   | 350   | 400   | 450   | 500   |
| H mm                       | 230 | 265  | 300 | 340 | 370   | 415   | 460   | 555   | 665   | 730   |
| Weight Kg                  | 10  | 13   | 17  | 24  | 31    | 41    | 55    | 89    | 140   | 180   |
| Handwheel Ø mm             | 125 | 150  | 175 | 175 | 200   | 200   | 225   | 225   | 250   | 300   |
| Turns open/close nr        | 10  | 12,5 | 16  | 20  | 25    | 25    | 30    | 40    | 42    | 50    |
| Max torque gate closing Nm | 30  | 30   | 35  | 35  | 40    | 45    | 45    | 60    | 90    | 90    |
| Kvs value                  | 107 | 250  | 430 | 790 | 1.250 | 1.960 | 2.790 | 2.880 | 4.306 | 6.380 |

EN\_135hta - Edition 02/2022 • Maran e Peracini srl assumes no responsibility or liability for typographical errors or omissions and reserves the right to change without notice.

## Valvola a saracinesca in ghisa grigia a Corpo Ovale vite interna sede ottone PN16 per Alte Temperature con modulo di accoppiamento ISO 5210 F10

### Principali caratteristiche

- Prodotta in Italia in accordo a EN 1171
- Scartamento secondo EN 558-1, serie 15
- Connessioni flangiate secondo EN 1092-2 PN16 con risalto (non forate, PN10 o secondo altre specifiche disponibili su richiesta)
- Stelo interno, chiusura in senso orario, tenuta secondaria sullo stelo tramite O-ring
- Minima perdita di carico
- Testata idraulicamente secondo EN 12266-1: Test tipo P11-P12 Rate A
- Conforme alla Direttiva Attrezzature in Pressione PED 2014/68/UE art. 13 Fluidi di gruppo 2
- 100% passaggio totale

### Settori di utilizzo

- Impianti industriali
- Acque reflue
- Impianti trattamento acque
- Sistemi di condizionamento (HVAC)
- Centrali termiche e circuiti di raffreddamento
- Fluidi non aggressivi
- Serbatoi
- Irrigazione
- Carburanti

### Protezione dalla corrosione

- Versione Standard: rivestita esternamente con vernice ad alta resistenza alla corrosione con resina oleofenolica ai fosfati di zinco Grigio Ral 7011
- Su richiesta: verniciatura integrale epossidica
- Altre tonalità disponibili



### Condizioni di esercizio

|                                |             |              |
|--------------------------------|-------------|--------------|
| Temperature fluido (°C)        | -10 to +120 | +120 to +150 |
| Massima pressione fluido (bar) | 16          | 14           |

### Test idraulico secondo EN 12266-1 (bar)

|           |                  |                 |
|-----------|------------------|-----------------|
| P11 Corpo | P12 Sedi (acqua) | P12 Sedi (aria) |
| 24        | 18               | 6               |

### Specifica materiali

| Nr | Parte                 | Materiale                    | Norma       |
|----|-----------------------|------------------------------|-------------|
| 1  | Consol-flange ISO5210 | Acciaio al carbonio zincato  | A105        |
| 2  | O-ring                | DF801 FKM 80SH               | -           |
| 3  | Guarnizione           | Fasit 205                    | -           |
| 4  | Asta                  | X12Cr13 acciaio inossidabile | AISI 410    |
| 5  | Cappello              | EN-GJL-250 ghisa grigia      | EN 1561     |
| 6  | Guarnizione           | Fasit 205                    | -           |
| 7  | Madrevite             | Acciaio al carbonio          | A 105       |
| 8  | Cuneo DN 40-DN 65     | CB 754-S GM ottone fuso      | EN 1982     |
| 8  | Cuneo DN 80-DN 300    | EN-GJL-250 ghisa grigia      | EN 1561     |
| 9  | Sedi                  | CB 754-S GM ottone fuso      | EN 1982     |
| 10 | Corpo                 | EN-GJL-250 ghisa grigia      | EN 1561     |
| 11 | Dado                  | Acciaio zincato 8.8          | ISO 4032    |
| 12 | Vite                  | Acciaio zincato 8.8          | EN ISO 4017 |

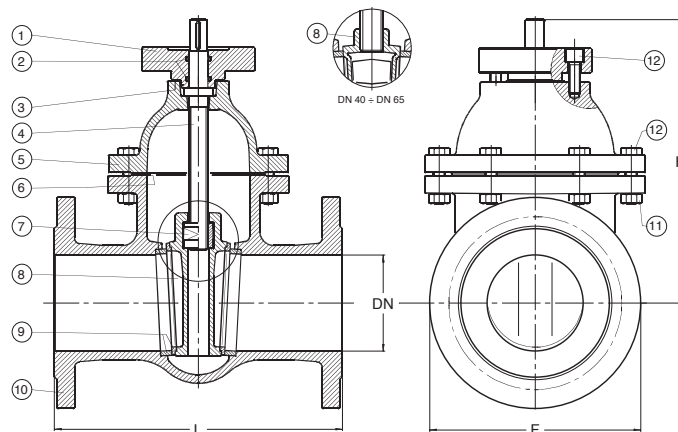

### Dati tecnici

| DN                              | 40  | 50   | 65  | 80  | 100   | 125   | 150   | 200   | 250   | 300   |
|---------------------------------|-----|------|-----|-----|-------|-------|-------|-------|-------|-------|
| F mm                            | 150 | 165  | 185 | 200 | 220   | 250   | 285   | 340   | 405   | 460   |
| L mm                            | 240 | 250  | 270 | 280 | 300   | 325   | 350   | 400   | 450   | 500   |
| H mm                            | 230 | 265  | 300 | 340 | 370   | 415   | 460   | 555   | 665   | 730   |
| Peso Kg                         | 10  | 13   | 17  | 24  | 31    | 41    | 55    | 89    | 140   | 180   |
| Volantino Ø mm                  | 125 | 150  | 175 | 175 | 200   | 200   | 225   | 225   | 250   | 300   |
| Giri apertura/chiusura nr       | 10  | 12,5 | 16  | 20  | 25    | 25    | 30    | 40    | 42    | 50    |
| Momento torcente in chiusura Nm | 30  | 30   | 35  | 35  | 40    | 45    | 45    | 60    | 90    | 90    |
| Perdite di carico Kvs           | 107 | 250  | 430 | 790 | 1.250 | 1.960 | 2.790 | 2.880 | 4.306 | 6.380 |

IT\_135hta - Edizione 02/2022 • Maran e Peracini srl si riserva il diritto di apportare variazioni senza preavviso.